

CONCRETE SLAB SURFACE
1:2:4, 10CM THICK

CONCRETE FILL, 1:3:6

PRECAST CONCRETE PIPE
DIA 60CM, 5CM THICK

CONCRETE SLAB BASE
1:4:8, 15CM THICK

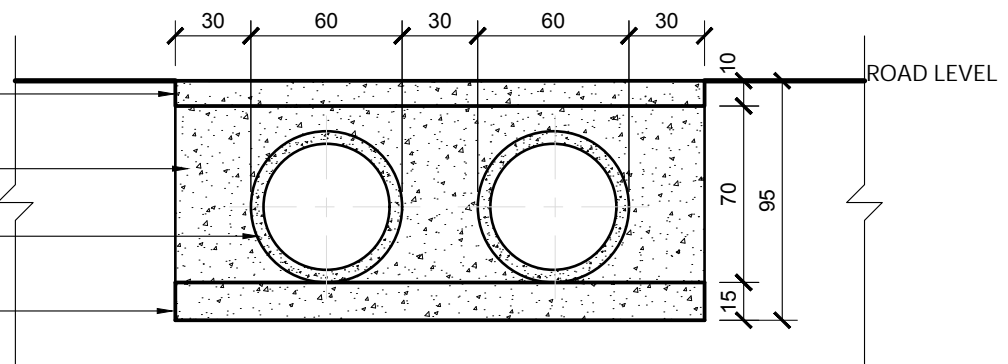

CONCRETE SLAB SURFACE
1:2:4, 10CM THICK

CONCRETE FILL, 1:3:6

PRECAST CONCRETE PIPE
DIA 60CM, 5CM THICK

CONCRETE SLAB BASE
1:4:8, 15CM THICK

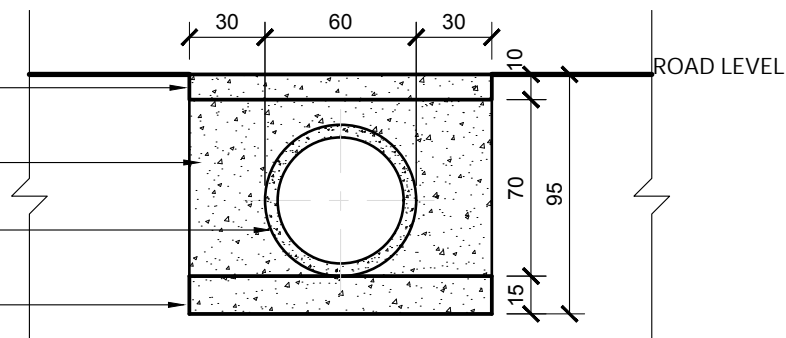

1. Refer to Specification for material descriptions.
2. Structural design to be verified by local engineer for compliance with local conditions and norms
3. Ensure the correct water content of mixed concrete - slump test should yield $< 1/4$ height reduction.
4. Slabs to be cast in a single pour. All concrete works to be vibrated or well rodded.
5. Ensure all poured concrete is kept damp and out of direct sunlight for at least 7 days while curing.
6. Span and height dimensions nominal - adjust to suit site conditions and requirements.



Technical Support Section
Community Infrastructure Catalogue